

NW SEC COR      1/4 SEC 200      N 1/4 COR      1/4 SEC 100      NE SEC COR

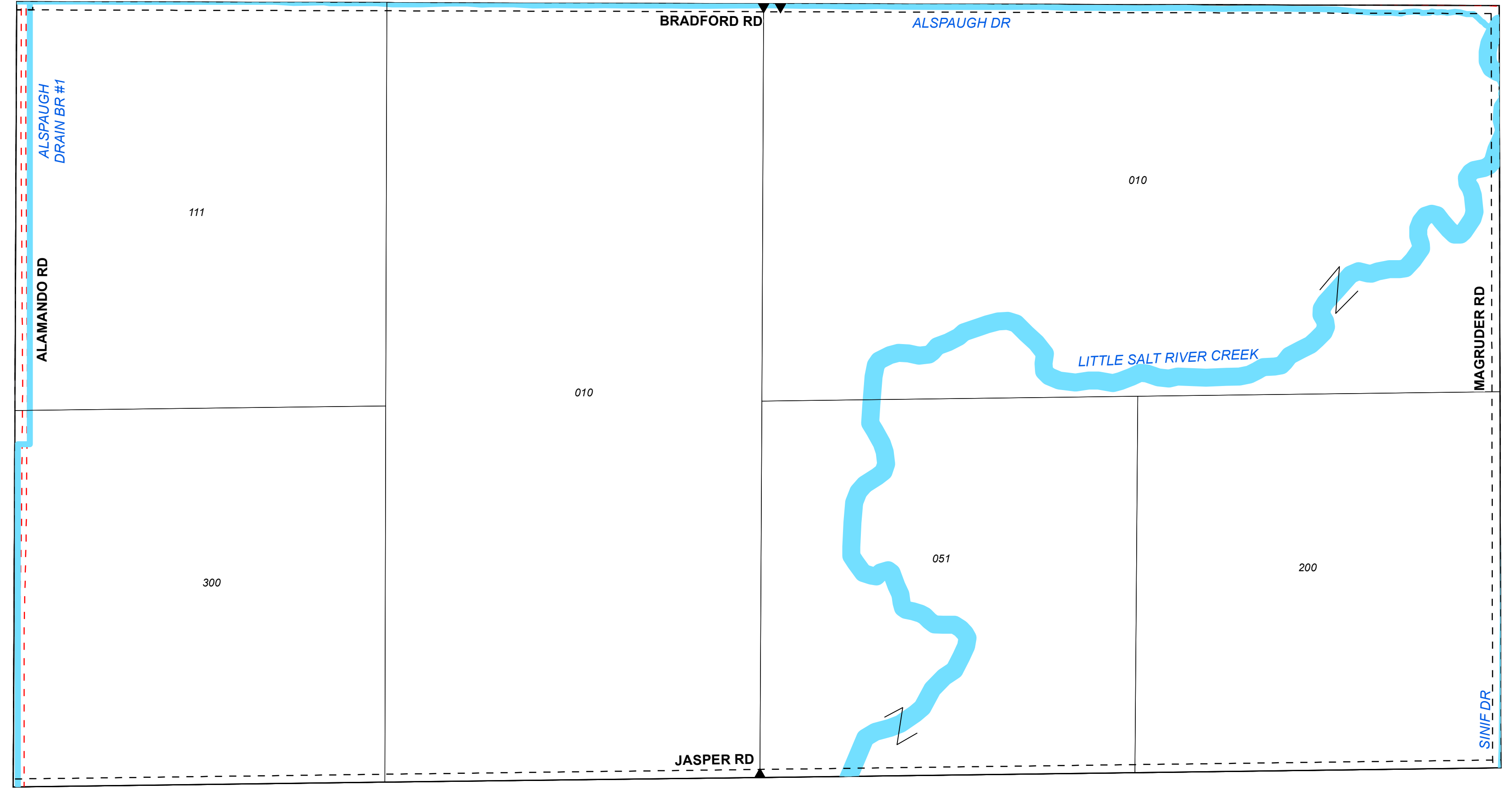

W 1/4 COR      CENTER SEC COR      E 1/4 COR

1 inch = 300 feet  
**JASPER TOWNSHIP**  
Midland County

T13NR02W

N1/2SEC2

Revised: \_\_\_\_\_